



oors.

Product catalogue.

KFV

KAFLI®

WINDOW HARDWARE

DOOR HARDWARE

SLIDING DOOR HARDWARE

VENTILATION AND BUILDING TECHNOLOGY

Reprinting or reproduction of catalogue pages is not permitted without our written authorisation.

All article descriptions and technical specifications correspond to the state of our production on the date that this catalogue was published.

We reserve the right to make changes.

We assume no liability for printing errors and other errors.

April 2014

Interior doors

104 ½, 104

Mortise lock for lightweight interior doors

Item	For flush doors	For rebated doors DIN 18251-1	
104 ½ BB		Class 2	Metal latch and deadbolt, Lever lock with 2 keys, single-turn.
104 ½ WC		Class 2	Metal latch and deadbolt, for bathrooms, single-turn.
104 BB	✓		Metal latch and deadbolt, Lever lock with 2 keys, single-turn.
104 WC	✓		Metal latch and deadbolt, for bathrooms, single-turn.

Version

Closed zinc plated lock case, spindle square 8 mm.
Backset: 55 mm
Face plate: 24 mm for flush doors,
Face plate: 20 mm for rebated doors,
Finish: old silver lacquered,
with strike plate.

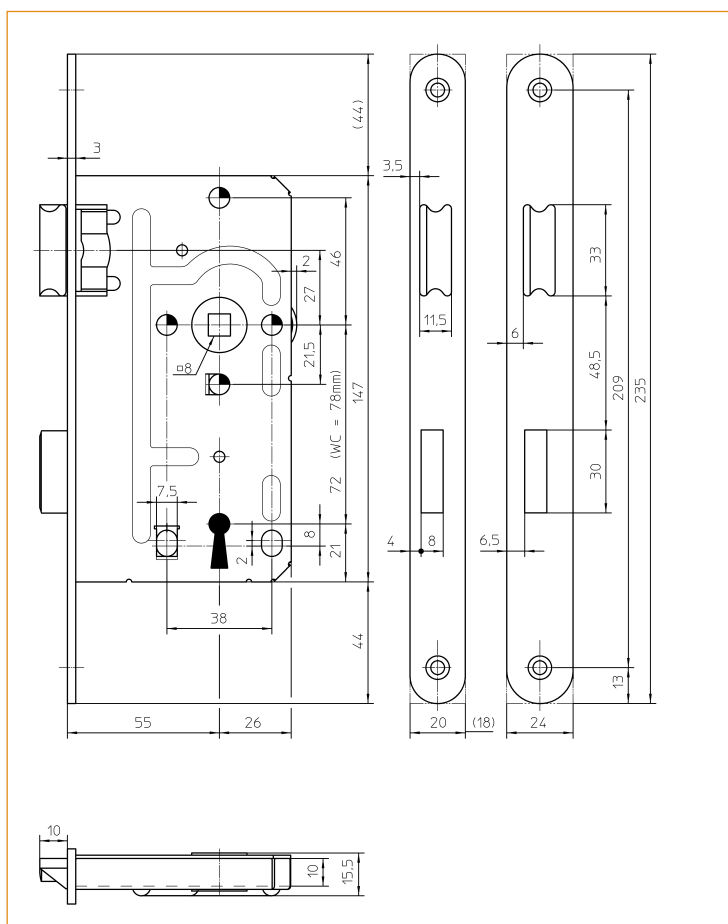
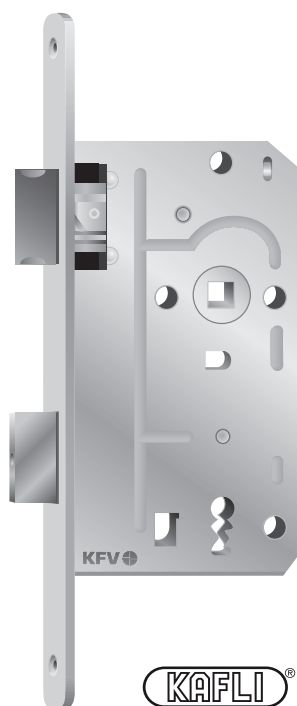

114 ½, 114

Mortise lock for interior and exterior doors

Item	For flush doors	For rebated doors DIN 18251-1	
114 ½ PZW		Class 2	Prepared for euro profile cylinder, with latch retraction, double-turn.
114 ½ BB		Class 2	Lever lock with 2 keys, single-turn.
114 ½ WC		Class 2	Bathroom lock, 10.5 mm deadbolt single-turn.
114 PZW	✓		Prepared for euro profile cylinder, with latch retraction, double-turn.
114 BB	✓		Lever lock with 2 keys, single-turn.
114 WC	✓		Bathroom lock, 10.5 mm deadbolt single-turn.

Version

Zinc diecast latch and deadbolt, non turnable latch, closed zinc plated lock case, spindle square 8 mm.

Backset: 55 mm

Face plate: 24 mm for flush doors

Face plate: 20 mm, for rebated doors,

Finish: old silver laquered with strike plate.

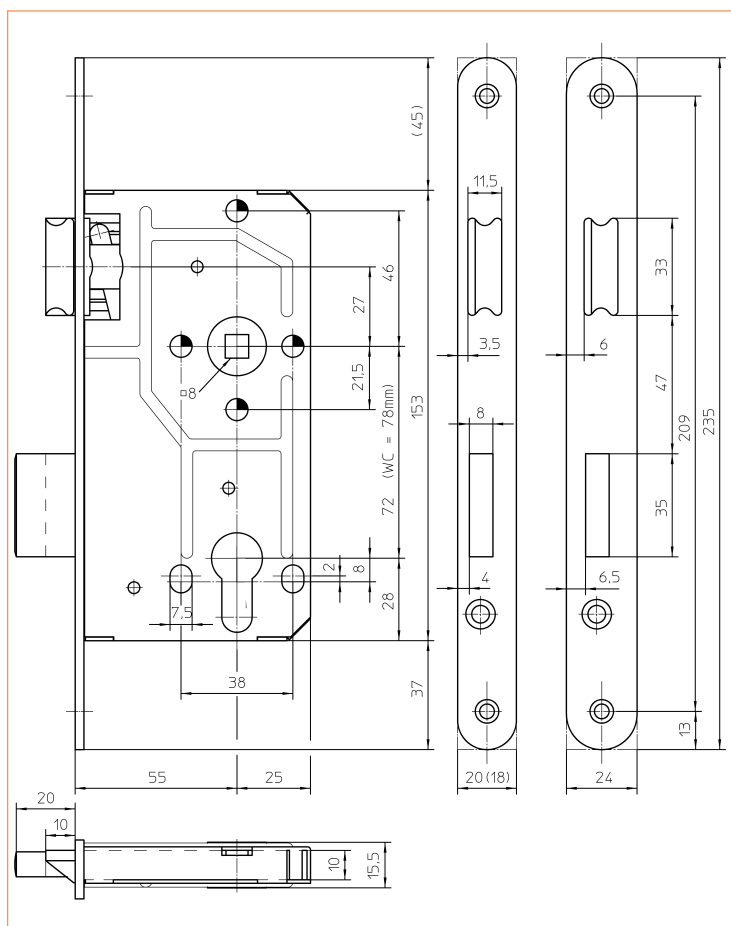
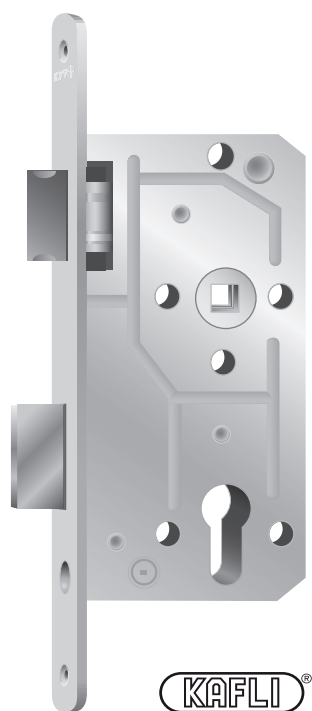

706 ½, 706

Mortise door lock for interior and exterior doors, heavy duty, can be used on the right and left, CE 0757, EN 12209, fire rated

Item	For flush doors	For rebated doors	
706 ½ PZW		✓	Prepared for euro profile cylinder, with latch retraction, double-turn.
706 ½ BB		✓	Lever lock with 2 keys, double-turn.
706 ½ WC		✓	Bathroom lock, 10.5 mm deadbolt single-turn.
706 ½ F		✓	Latch lock (without deadbolt).
706 ½ R PZ		✓	Deadbolt (without latch), prepared for euro profile cylinder, double-turn.
706 PZW	✓		Prepared for euro profile cylinder, with latch retraction, double-turn.
706 BB	✓		Lever lock with 2 keys, double-turn.
706 WC	✓		Bathroom lock, 10.5 mm deadbolt single-turn.
706 F	✓		Latch lock (without deadbolt).

Version

With turnable latch, zinc plated latch and deadbolt, closed zinc plated lock case, spindle square 8 mm.

Backset: 40, 45, 55 and 70 mm

Face plate: 24 mm for flush doors

Face plate: 20 mm for rebated doors with strike plate.

Finish: stainless steel,
brass polished,
old silver laquered,
yellow laquered.

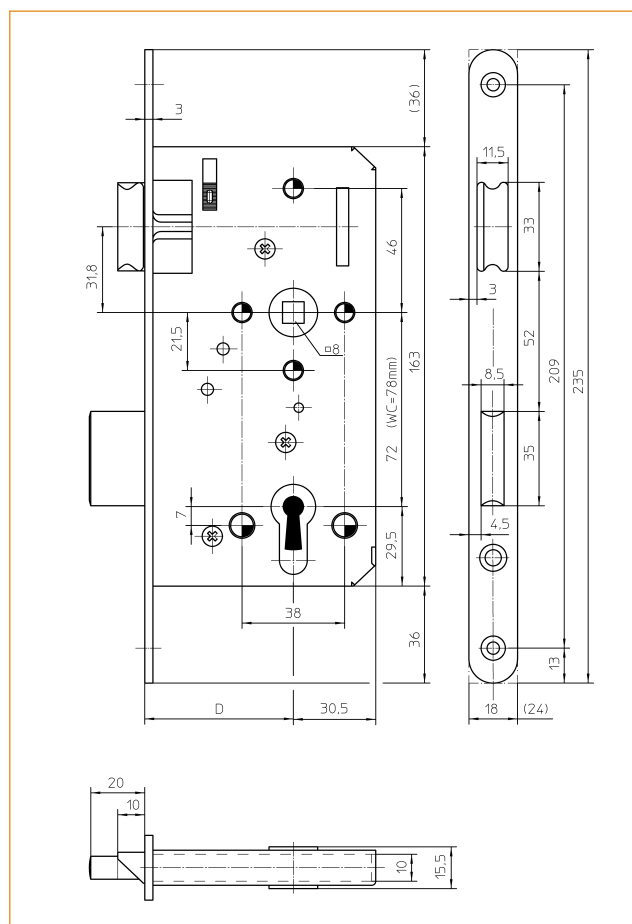
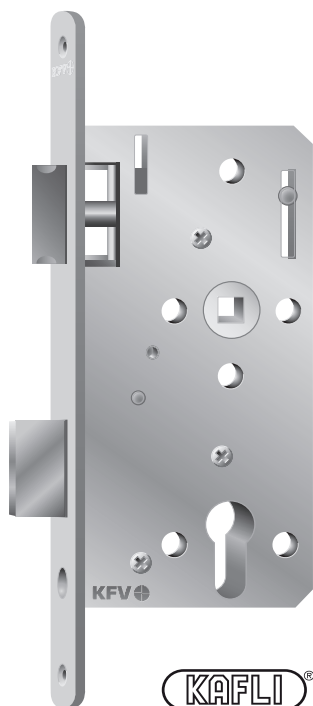

116 1/2

Magnetic mortise door lock for interior and exterior doors,
can be used on the right and left

Item	For flush doors	For re-bated doors	
116 1/2 PZW	✓	✓	Prepared for euro profile cylinder, with latch retraction, double-turn.
116 1/2 BB	✓	✓	Lever lock with 2 keys, double-turn.
116 1/2 WC	✓	✓	Bathroom lock, 10.5 mm deadbolt single-turn.
116 1/2 F	✓	✓	Latch lock (without deadbolt).

Magnetic latch, bright nickel plated deadbolt,
closed zinc plated lock case, spindle square 8 mm.
Backset: 55 mm
Face plate: 18 mm, 20mm
Finish: stainless steel.

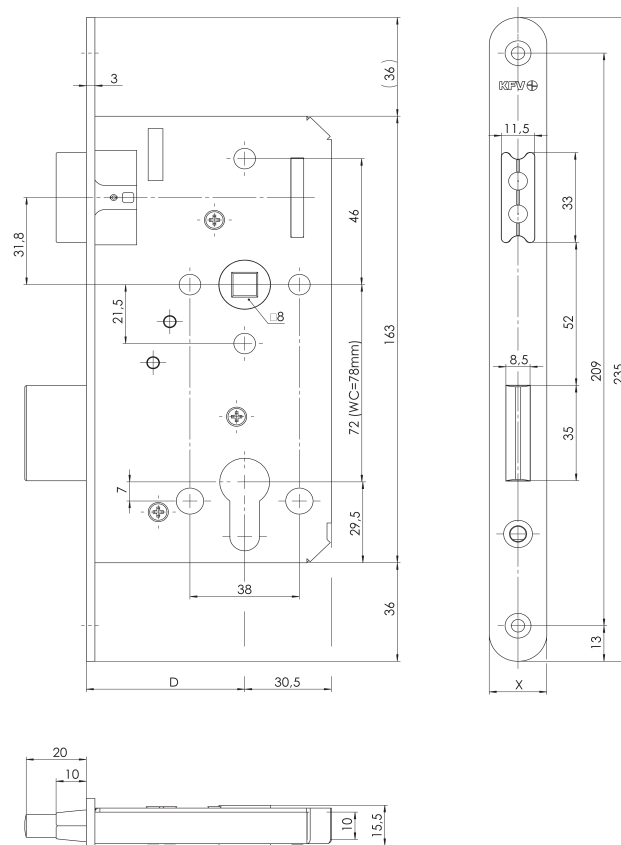

211

Mortise deadbolt lock.

Item	For flush doors	For re-bated doors	
211 PZ	✓	✓	Prepared for euro profile cylinder, double-turn.
211 WC	✓	✓	Bathroom lock, 10.5 mm deadbolt single-turn.

Version

Bright nickel plated deadbolt, zinc plated lock case.

Backset: 55 mm, 60 mm, 65 mm

Face plate: 20 mm,
with strike plate.

Finish: stainless steel,
brass polished,
old silver laquered,
yellow laquered.

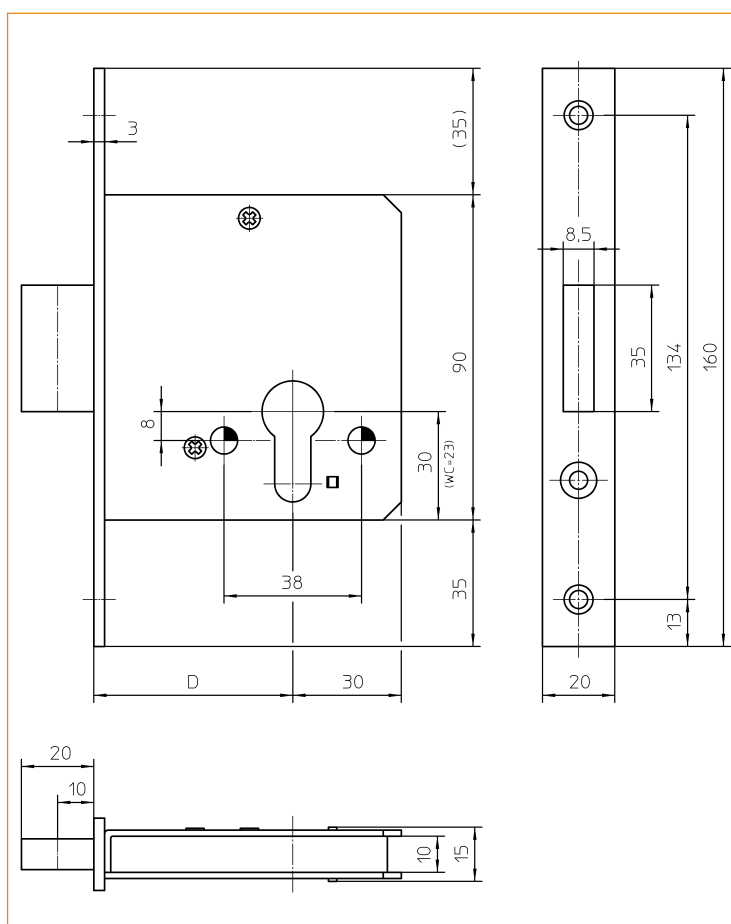

486

Mortise swing door lock with adjustable roller latch, heavy duty.

Item	For flush doors	For rebated doors	
486 PZ			Prepared for euro profile cylinder, double-turn.

Version

Adjustable roller latch, roller latch and deadbolt nickel plated, zinc plated lock case.

Backset: 55 mm, 60 mm, 65 mm

Face plate: 24 mm,
with strike plate.

Finish: stainless steel,
old silver laquered,
brass polished,
yellow laquered.

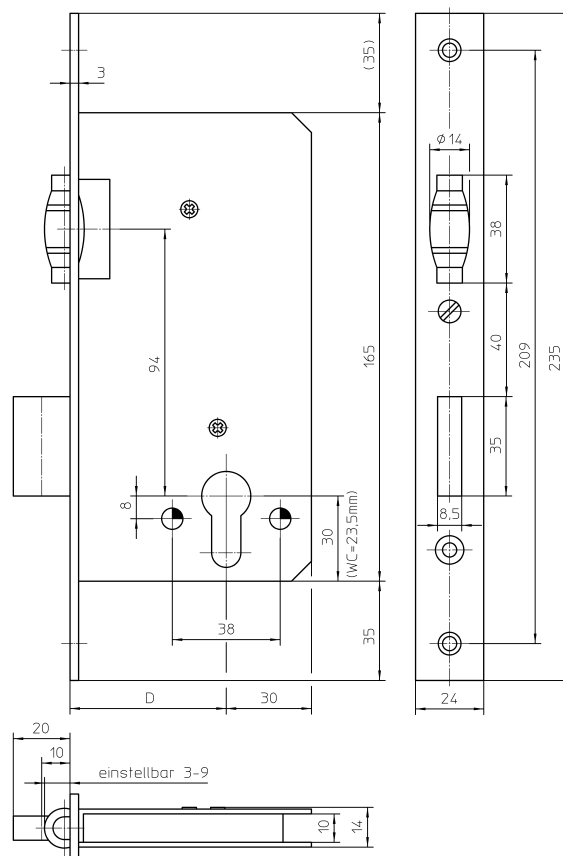

1620

Mortise sliding door lock, with hookbolt.

Item	For flush doors	For rebated doors	
1620 PZ			Prepared for euro profile cylinder.
1620 BB			Lever lock with 2 folding ring keys.
1620 WC	✓	✓	Bathroom lock.

Version

Zinc plated lock case, bright nickel plated hookbolt.

Backset: 55 mm

Face plate: 24 mm,
with strike plate.

Finish: stainless steel,
old silver lacquered,
yellow laquered,
brass polished.

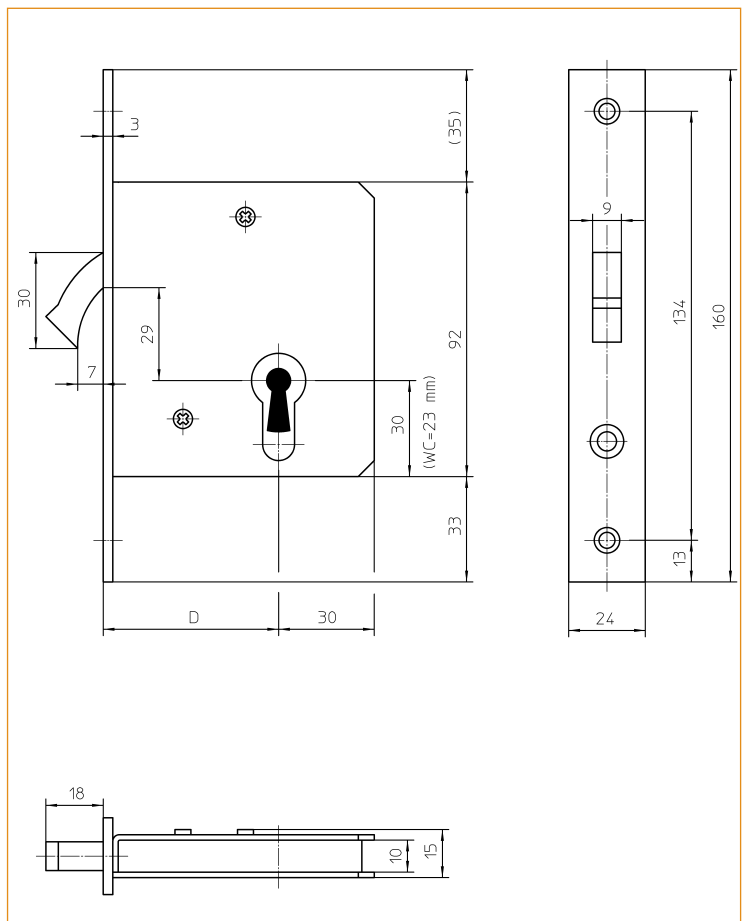

28

Mortise locks for metal or uPVC doors,
15 mm deadbolt projection.

Item	DIN 18251-2	
28 PZW	Class 1	Prepared for euro profile cylinder, with latch retraction, single throw deadbolt.

Version

Can be used on the right and left due to reversible latch,
zinc plated latch and deadbolt, deadbolt projection 15 mm,
zinc plated lock case.
Backset: 20, 30 and 35 mm
Face plate: 24 mm
Finish: zinc plated,
stainless steel.

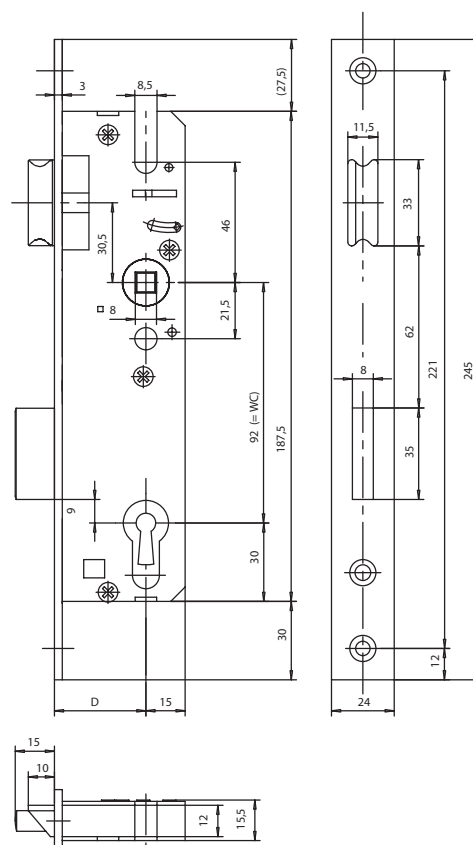

25 mm deadbolt projection

29

Mortise locks for metal or uPVC doors, heavy duty,
25 mm deadbolt projection.

Item	
29 PZW	Prepared for euro profile cylinder, with latch retraction, double throw deadbolt.

Version

Can be used on the right and left due to reversible latch,
zinc plated latch and deadbolt, deadbolt projection 25 mm,
deadbolt secured against sawing through inserted hardened
steel pins, zinc plated lock case.
Backset: 30 and 40 mm
Face plate: 24 mm
Face plate with lubricant nipple.
Finish: zinc plated,
 stainless steel.

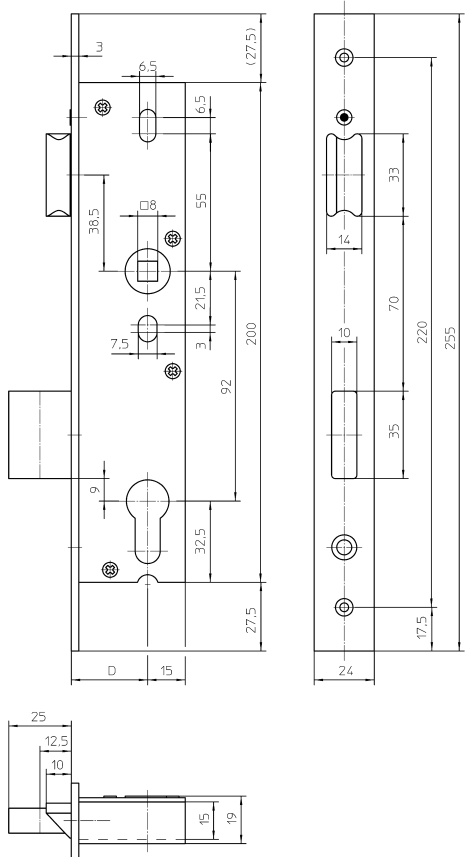

59

Mortise locks for metal or uPVC doors, heavy duty,
25 mm deadbolt projection.

Item	
59 PZW	Prepared for euro profile cylinder, with latch retraction, double throw deadbolt.

Version

Can be used on the right and left due to reversible latch,
bright nickel plated latch and deadbolt, deadbolt secured
against sawing through inserted steel pins, 25 mm deadbolt
projection, zinc plated lock case.
Backset: 30, 35, 40, 45, 55 and 65 mm
Face plate: 24 mm, with lubricant nipple.
Finish: zinc plated,
stainless steel.

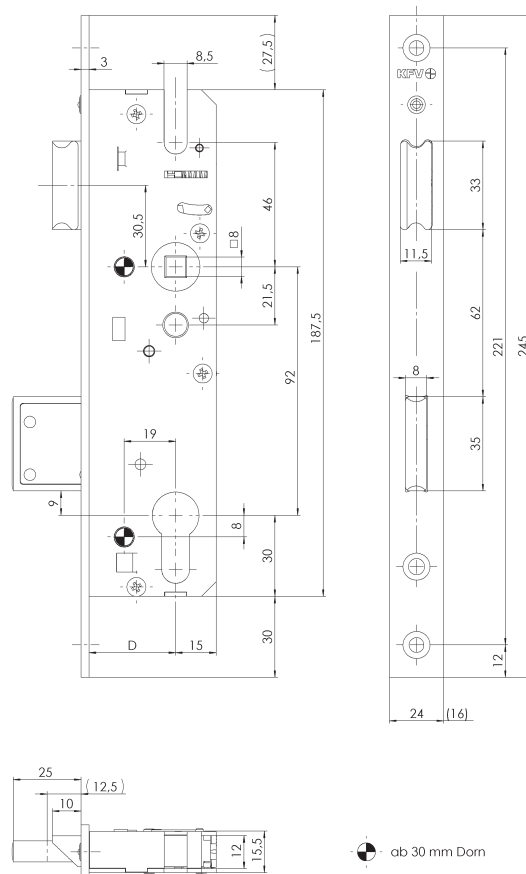

25 mm deadbolt projection

30

Mortise locks for metal or uPVC doors,
25 mm deadbolt projection.

Item	
30 PZ	Prepared for euro profile cylinder, double throw deadbolt.

Version

Can be used on the right and left, zinc plated lock case,
bright nickel plated deadbolt, deadbolt projection 25 mm,
deadbolt secured against sawing through inserted hardened
steel pins.

Backset: 20, 25 and 30 mm

Face plate: 24 mm

Finish: zinc plated,
stainless steel.

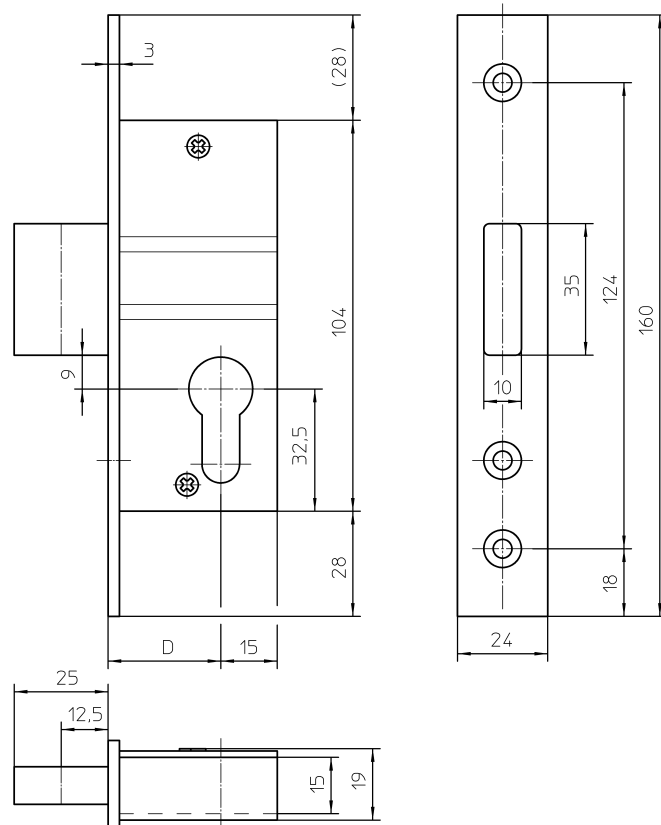

60

Mortise deadbolt locks for metal or uPVC doors,
25 mm deadbolt projection.

Item	
60 PZ	Prepared for euro profile cylinder, double throw deadbolt.

Version

Bright nickel plated deadbolt, deadbolt secured against sawing through inserted steel pins, 25 mm deadbolt projection, zinc plated lock case.

Backset: 30, 35, 40 and 45 mm

Face plate: 24 mm

Finish: zinc plated,
stainless steel.

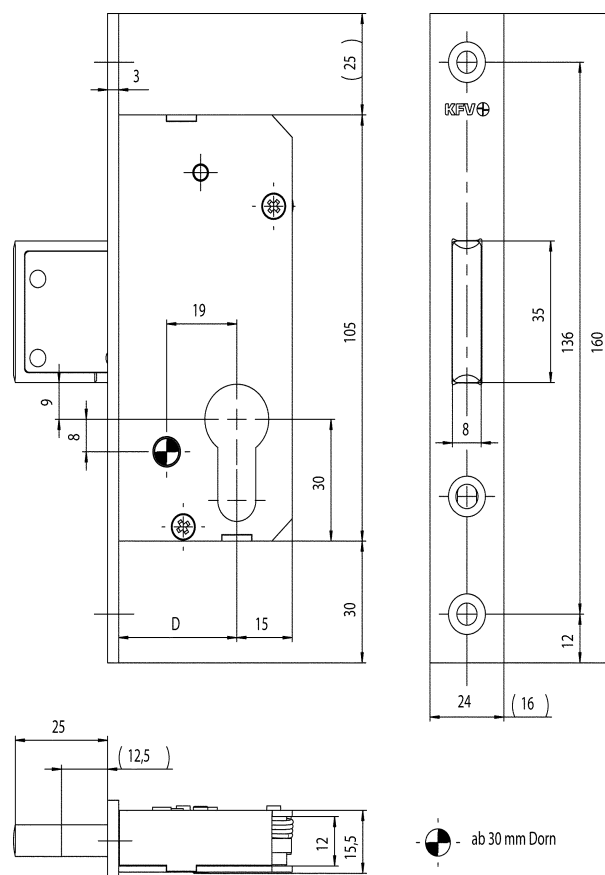

31

Item	
31 PZ	Prepared for euro profile cylinder, with roller latch, double throw deadbolt.

Adjustable roller latch lock,
roller latch and deadbolt nickel plated,
deadbolt secured against sawing through inserted hardened
steel pins, deadbolt projection 25 mm,
zinc plated lock case.
Backset: 25, 30 and 35 mm
Face plate: 24 mm, with lubricant nipple.
Finish: zinc plated,
stainless steel.

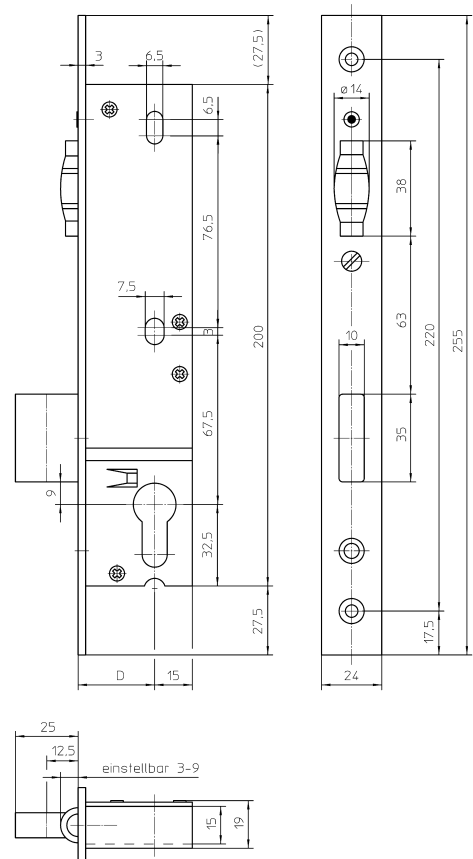

61

Mortise swing door lock for metal or uPVC doors with adjustable roller latch, heavy duty.

Item	
61 PZW	Prepared for euro profile cylinder, double throw deadbolt.

Version

Adjustable roller latch lock, roller latch and deadbolt bright nickel plated, deadbolt secured against sawing through inserted hardened steel pins, deadbolt projection 25 mm, zinc plated lock case.

Backset: 30, 35, 40 and 45 mm

Face plate: 24 mm, with lubricant nipple.

Finish: zinc plated,
stainless steel.

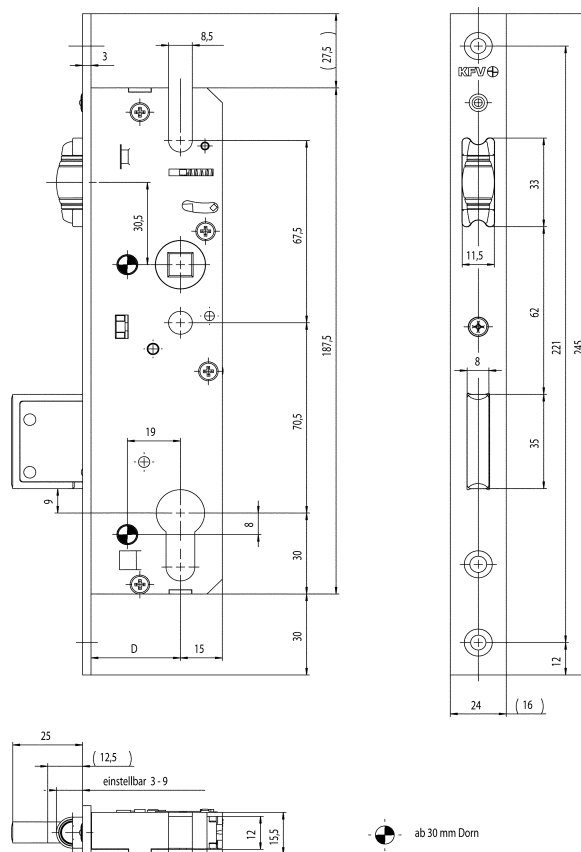

15 mm deadbolt projection

88

Mortise swing door lock for metal or uPVC doors with adjustable roller latch.

Item	
88 PZ	Prepared for euro profile cylinder, single throw deadbolt.

Version

Adjustable roller latch lock,
roller latch and deadbolt blue chromated,
deadbolt projection 15 mm, zinc plated lock case.
Backset: 20, 24, 26, 30, 35, 40 and 45 mm
Face plate: 24 mm
Finish: zinc plated,
 stainless steel.

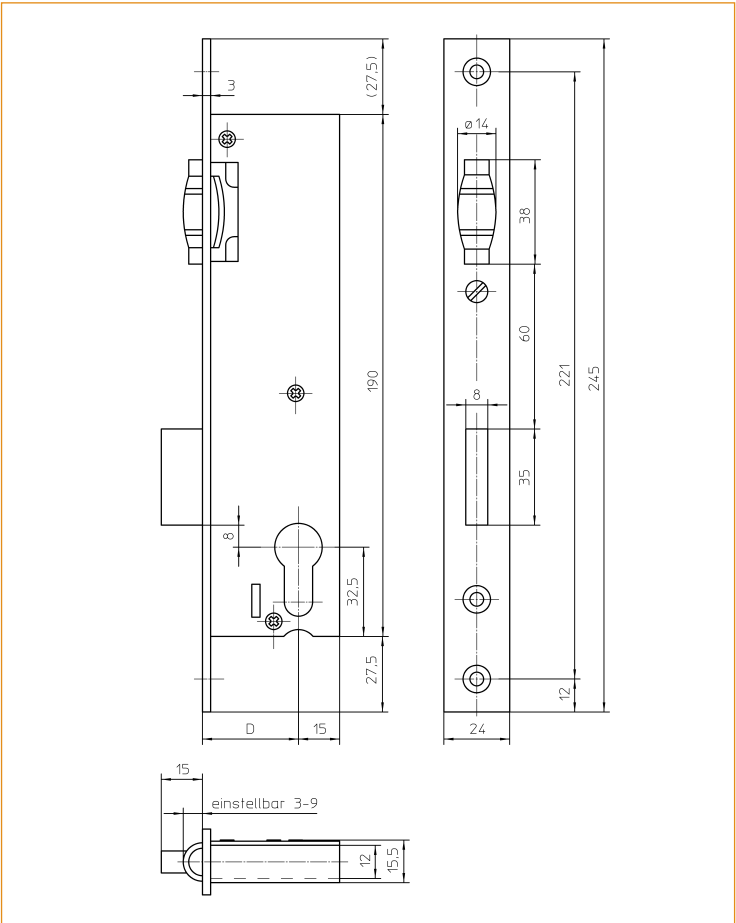

Multi-point locks with uniform dimensions.

Our multi-point locks, with uniform dimensions, are intelligent modular systems that make your work considerably easier. The new generation of multi-point locks are characterised by standardised routing details of the different lock types.

The advantages are obvious: simple to change, easy to retrofit, more options are available through the selection of variants, simplified stockholding levels, easy prehandling, lower service costs on-site. In short: Our multi-point locks with uniform dimensions help you to more effectively tap into your full potential.



Precisely tailored to your customer's needs: key operated or lever operated.



Lock and unlock with a double key turn.



Locking and unlocking from inside using the handle:

- 1 Lock
- 2 Resting Position
- 3 Unlock, Key can be used to block

AS 2750

Simply pull it shut.

The difference is two additional spring loaded soft-lock latches in the additional lock cases: Always locked with three latches, the AS 2750 protects constantly against door warping and even offers high basic security when unlocked. In addition, the key-activated lock, the hook latch combination, together with the deadbolt of the main lock, which is saw-proof, prevents intruders breaking in or prising open the door. The easily operated gear ensures good compression sealing, as well as excellent heat and sound insulation.



All advantages of the AS 2750:

- Three latches impede break-in attempts due to the retracting movement of the latch
- Hook latch combination prevents break-ins and the door being prised open for greater protection against break-ins up to RC3
- Three soft-lock latches protect against door warping
- Optimum seal, heat and sound insulation
- With optional door security lock
- Locking rail E3Q allows combination with the daytime latch
- Suitable for apartment doors, residential front doors and the commercial sector



Automatic

AS 3500

**Increased locking convenience with AS 3500:
Contactless magnet technology, solid Hookbolts and flush appearance.**

The new AS 3500 is an automatic multi-point lock in which two solid hookbolts are triggered using magnet technology. The hooks extend by 20 mm to lock, are locked into the end position using back pressure and lock upwards. This ensures that the lock functions properly even if the door is warped.

The hooks are only triggered when the patented magnetic trigger contacts the face plate. The trigger compensates for airgap tolerance automatically. The AS 3500's magnetic triggering technology makes it the only automatic lock without additional release latches.

All benefits at a glance:

- Automatic triggering using contactless magnet technology – without release latches
- High security thanks to solid hook bolts
- No locking problems with warped doors thanks to bottom-up locking mechanisms
- Main lock with maintenance-free, plastic-coated soft-lock latch with a pleasant locking sound
- Face plate generally made of stainless steel
- Available for door heights between 1600 and 2400 mm
- Clippable magnetic triggers make it possible to use all KFV standard striker plates with Q adjustment

The options:

The AS 3500 has many functions and a modular design.
The following options can be retrofitted:

Automated latch release:

Mechanical locking, electromechanical unlocking

Door security lock:

Restrictors concealed in the rebate prevent damage to the element from door chains, which detract from the appearance.

The backset of the door restrictor is similar to the backset of the multi-point lock, which means that the turn button and handle are on a single optical axis.

Daytime unlocking mechanism:

Can be fitted instead of a door security lock to deactivate the automatic function (hook is not triggered).



GENIUS

Convenience and security at the push of a button.**New improved GENIUS:**

now it is even faster and quieter. GENIUS is our mechatronic release system. It combines the security properties of a mechanical multipoint lock with the convenience of modern electronics. At the same time, GENIUS can be combined with access control systems and numerous other applications, thus providing a variety of individual solutions. Depending on the design, it is suitable for use in both private houses as well as commercial and industrial projects.

Convenient and accessible.

GENIUS puts an end to the daily hassle with keys. For apartment buildings with a front door that is locked at night, GENIUS offers greater convenience. For example, in the event of late evening visitors, the front door can be easily unlocked via an intercom system – and then locked automatically when the door closes.

In particular, GENIUS makes life easier for the elderly or those living with a disability. When combined with a swing door drive, doors can be opened and closed fully at the touch of a button.

Trust is good. Access control is better.

When used commercially, GENIUS can be operated by access control systems, which assign specifically defined access rights for all rooms to employees. The Day / Night mode enables access to be synchronised perfectly with working hours. It is also possible to combine it with timers, alarm systems or swing door drives.

Various access control systems for use in private residential buildings are available from KfV: from wireless transponder to fingerprint access (biometrics), or the new KfVkeyless system with Smartphone App management.



Key operated

AS 8100

Multi-point Lock with lockcase an 4 adjustable mushrooms

Key-operated multi-point locks by KFV are locked by a double key turn. Two turns are also required for unlocking.

All benefits at a glance:

- Smooth-running gear
- Smooth latch lever operation
- Adjustable DIN direction
- Versions for Swiss round cylinder
- Variety of backsets available
- Various centre distances available
- With optional soft-lock latch
- Deadbolt of main lock case secured against sawing
- Can be combined with SIEGENIA KoPiBo strike plates

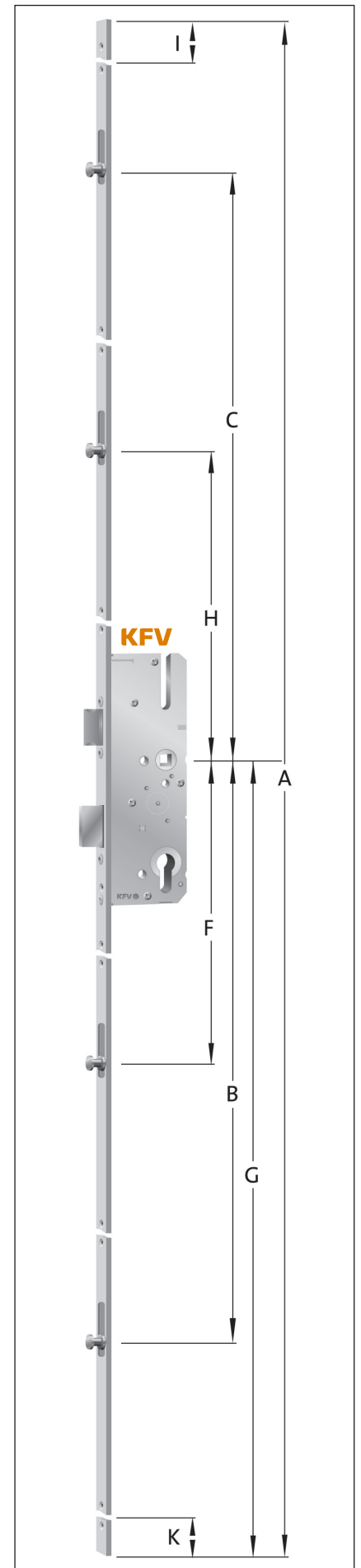

AS 4050

Multi-point Lock with lockcase an 4 adjustable locking cams

Handle operated multi-point locks require a door handle on the inside and outside and are locked by pulling the handle up. The significant lever force pulls the door into the seal. The handle then returns to its starting position using spring action and the door can be unlocked simply by pushing the handle down again. A single key turn will block the multi-point lock. It is unlocked again by turning the key once.

All benefits at a glance:

- Nickel plated latch and deadbolt
- Deadbolt of main lock case secured against sawing
- Adjustable DIN direction
- Powerful door tightening
- Easy operation mechanism

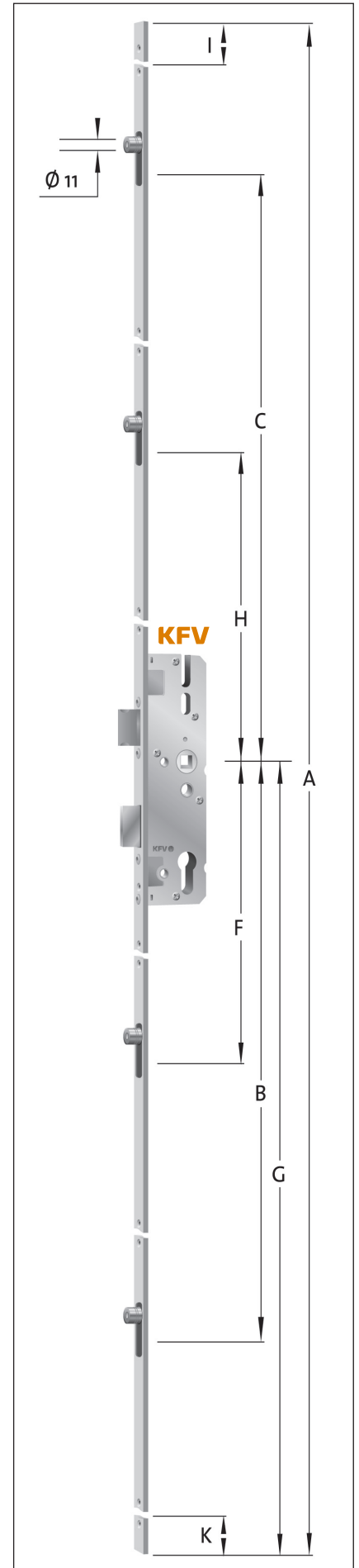

Emergency and Panic Exits

Fire rated, emergency exit, panic exit.

The turning point in an emergency.

In an emergency, every second counts. This is why KFV offers a full range of locks and multi-point locks that are characterised by maximum security, simple handling and powerful innovation.

Whether you require emergency exit locks in accordance with EN 179 or panic door locks in accordance with EN 1125, you can rely on the many product advantages of KFV. For example the 20 mm deadbolt projection with only one half turn of the key or the availability of mortise door locks, latch and deadbolt locks and multi-point locks.

Further product advantages in detail:



Cylinder with and without free-running cam.

- Cylinders with fixed or free-running catches as well as mechatronic cylinders with cross sections to DIN 18252 can be installed
- The maximum permissible position of the cam in the key withdrawal positions is 30°



Adjustable escape direction and DIN direction.

- Right, left and escape sides are individually adjustable thanks to the simple latch switch



All locking functions are possible.

- All locks and multi-point locks are available in all four locking functions (B, D or E)
- Keyless opening in the escape direction is always possible

Locking functions

All locks and multipoint locks for doors in emergency and panic exits can always be opened without a key in the escape direction, even if they are locked. The options for opening the door against the escape direction vary regarding the respective closing function of the locking part.

For all of the functions described below, the locking parts can be opened from the escape side in the same manner. The emergency exit locking part can only be opened using the handle on the door.

For systems with a "split spindle square" (functions B and D), the method for opening the door using the handle on the exterior side may vary.

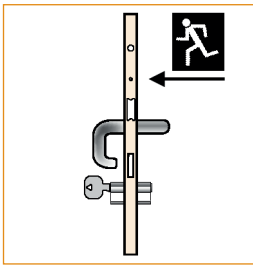

Change-over function B

The door can only be opened against the escape direction using the handle after it has been unlocked with the key. After the escape function has been activated, access against the escape direction is blocked once the door closes again, and it is not possible to escape back into the building.

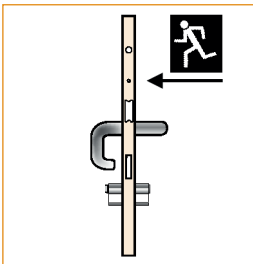

Free access function D

The door can only be opened against the escape direction using the handle after it has been unlocked with the key. After the escape function has been activated, the door is accessible from both sides and it is possible to escape back against the escape direction.

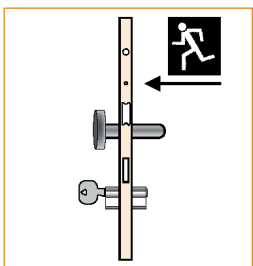

Key-operated latch function E

The door can only be opened against the escape direction after it has been unlocked and it can only be opened with the key. After the escape function has been activated, access against the escape function is blocked once the door closes and it is not possible to escape back into the building.

EP 166 72 mm distance,
prepared for profile cylinder,
face plate surface: brushed matt
stainless steel.

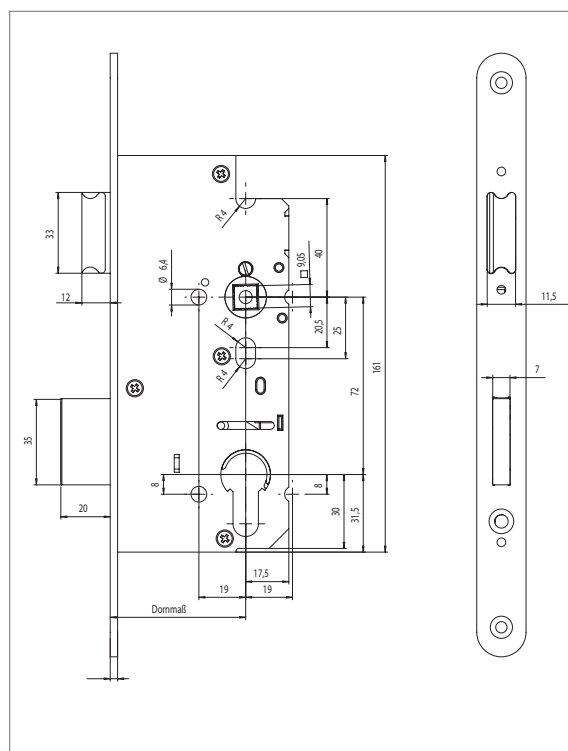

EP 99 92 mm distance,
prepared for profile cylinder,
20 mm deadbolt projection,
face plate surface: brushed matt
stainless steel.

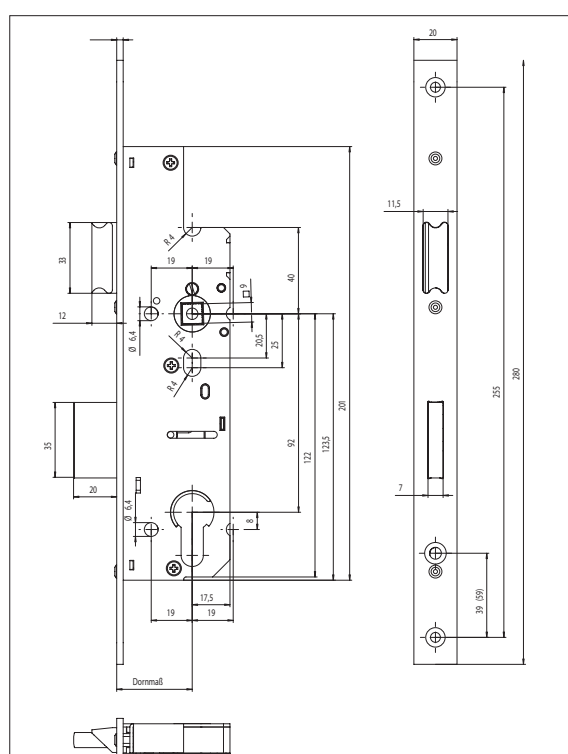

Powerful innovation: the double sash panic door locks from KFV

KFV has revolutionised the manufacturing process for double sash panic exit doors. The easy to install three-part solution minimises milling costs and enormously reduces the time required to produce an emergency secondary sash. The hardware in the side part accommodates the locking element of the active leaf. If the operating unit on the inactive leaf is activated, the main leaf automatically unlocks and the element can be used as an emergency escape with its full opening width. The inactive leaf hardware locks automatically on closing. Available for all current secondary sash profiles for timber, PVC and metal.

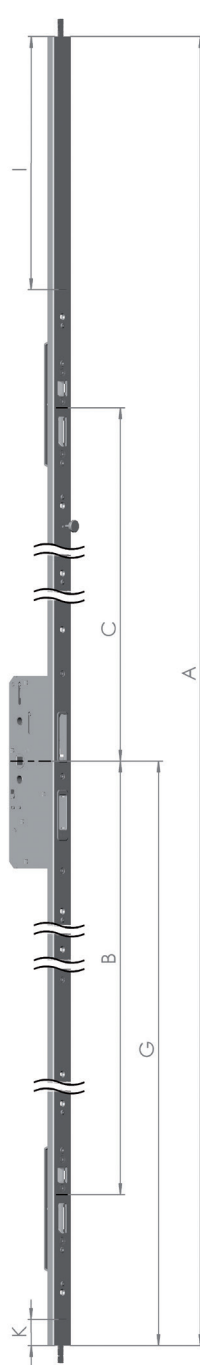

**Basic component
Inactive sash**

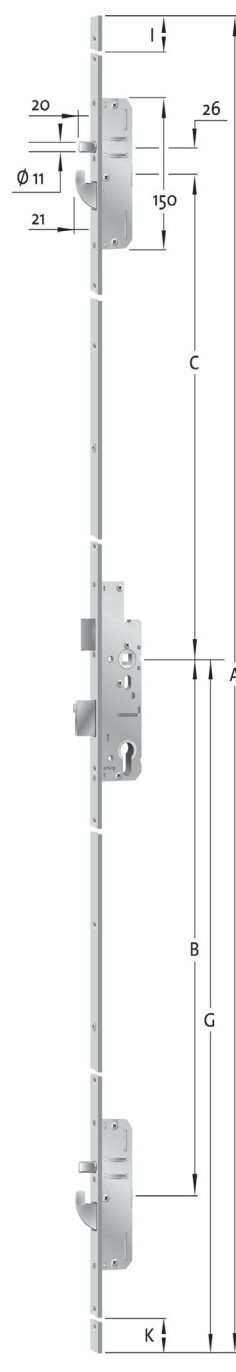

**Multi-point lock
Active sash**

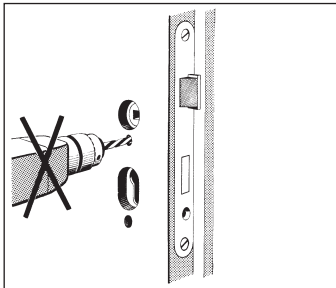

Do not drill through the door leaf in the closing area when the lock is installed.

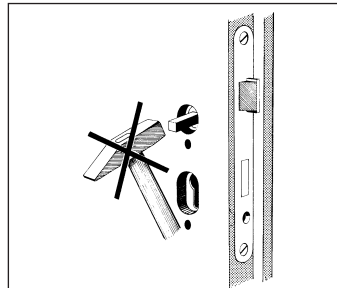

The spindle must not be pounded through the lock nut with force.

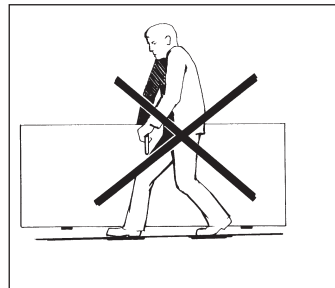

The door leaf must not be carried using the handle as a grip.

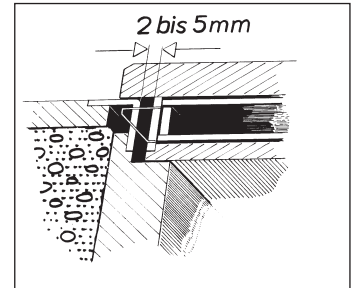

The distance between the lock face plate and striker plate must be between 2 and 5 mm.

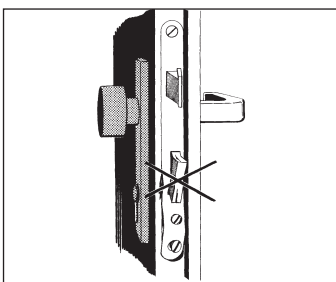

As soon as it becomes apparent that force has been used, the lock must be replaced.

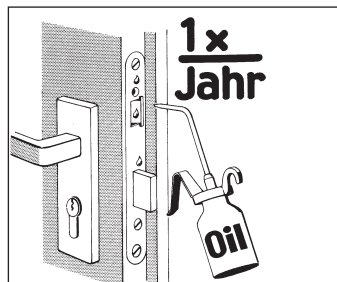

Locks must be lubricated at least once per year (do not use oils that exude resin).

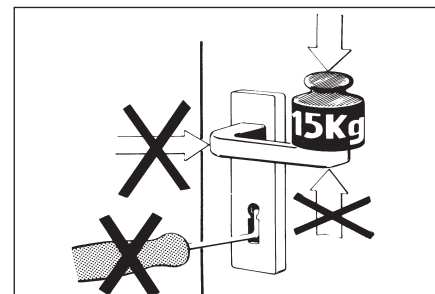

Force must be exerted on the handle only in the normal direction of rotation. A maximum force of 150 N may be applied to the handle in the direction of actuation. The lock must be locked only with the associated key (and not with foreign objects).

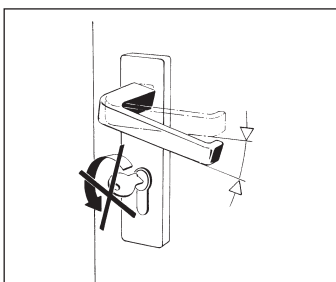

The handle and key must not be operated at the same time.

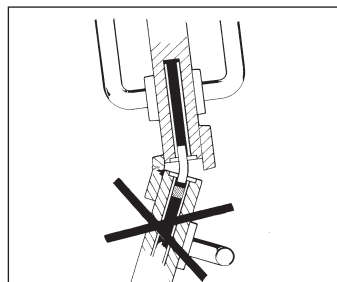

Double-leaf doors must not be forced open using the inactive leaf.

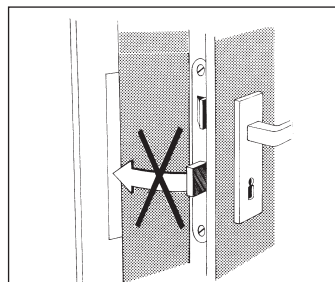

The lock must not be locked when the door is open.

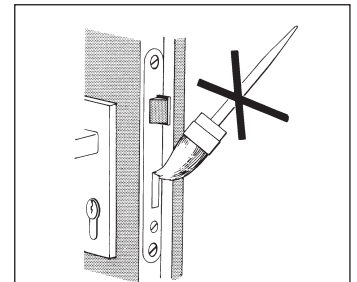

The lock and latch must not be painted over or coated.

Maintenance information

The surfaces of the fittings are not maintenance-free and should be cleaned on a regular basis according to their design.

For **metallic** surfaces (stainless steel, zinc-plated, etc.), use only mild, pH-neutral cleaning agents that have been diluted. Never use aggressive, acidic cleaning or abrasive agents, since these damage the corrosion protection of the door-furniture.

Coated surfaces should only be cleaned with a solvent-free cleaning agent and a soft, lint-free cloth.

KFV

A company of the SIEGENIA GROUP

KFV Karl Fliether GmbH & Co. KG
Siemensstraße 10
42551 Velbert
GERMANY

Phone: +49 2051 278-0
Fax: +49 2051 278-167
info@kfv.de
www.kfv.de



SIEGENIA-AUBI worldwide:

Austria Phone: +43 6225 8301
Belarus Phone: +375 17 3121168
Benelux Phone: +32 9 2811312
China Phone: +86 316 5998198
France Phone: +33 3 89618131
Germany Phone: +49 271 39310
Great Britain Phone: +44 2476 622000

Hungary Phone: +36 76 500810
Italy Phone: +39 02 9353601
Poland Phone: +48 77 4477700
Russia Phone: +7 495 7211762
South Korea Phone: +82 31 7985590
Switzerland Phone: +41 33 3461010
Turkey Phone: +90 216 5934151
Ukraine Phone: +380 44 4637979

Contact your dealer:



Haroon Company

	Dubai	Sharjah	Abu-Dhabi	Doha, Qatar
Telephone	+ 971 4 4539776	+ 971 6 533 7338	+ 971 2 621 8556	+ 974 4 475 9008
Facsimile	+ 971 4 4539774	+ 971 6 533 1819	+ 971 2 621 8567	+ 974 4 435 4253
E-mail	haroonco@eim.ae			